



WARDCRAFT Tee-Lift® System

Quick Die Change

Maximum Efficiency. Minimal Complexity.

The patented Tee-Lift® System from Wardcraft is a quick die change system that eliminates the need for hydraulic pumps by utilizing pneumatic lifts, which are powered by existing shop air, to position and maneuver dies. Accepted as one of the most economical and effective production improvement tools available in press-working today, this system helps increase the efficiency of your production line while reducing the costs associated with die set-up, transport and change-over time.

Simply Rugged

The Tee-Lift® System is a simple system comprised of rugged pneumatic air bags placed in the designated T-Slots of your press and custom-fit steel lift rails positioned above them. The rails feature crowned rollers, allowing your dies to move freely and easily when raised onto them. With spun polyester/TPU-lined air bags or hi-temp 500° F) silicone air bags, this system can sufficiently work with dies weighing up to 15 tons.

Ease of Operation

The Tee-Lift® System is incredibly easy to operate. With your die positioned over the system, the air

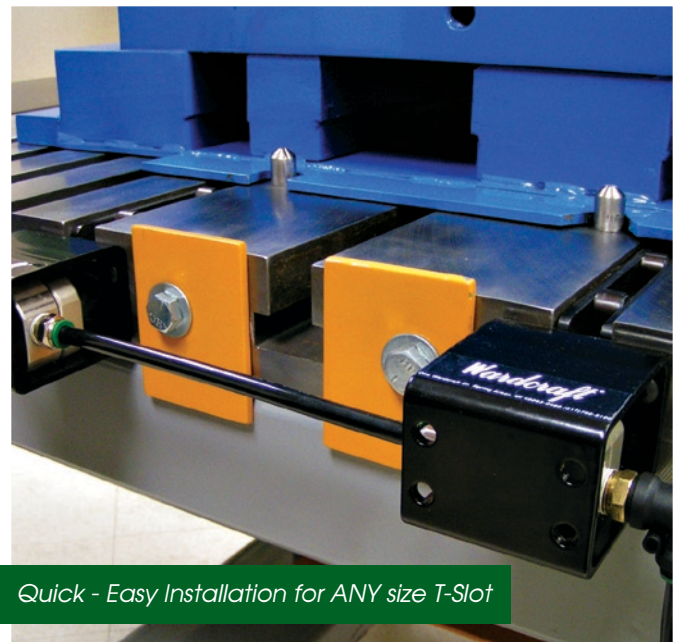

bags are inflated by the existing compressed air in your shop. The pneumatic bags will lift your die 1/8" onto the steel rollers, where it is then clear to be moved. When finished, the bags can be deflated to securely place the die back onto the press surface.





Since 1897

WARDCRAFT Conveyors Quick Die Change

One Wardcraft Drive
Spring Arbor
Michigan 49283

800.782.2779

info@wardcraft.net
WardcraftConveyor.com

Each Tee-Lift® is customized to fit your T-Slot

Required Information

- Determine the heaviest-weight die you wish to carry
- Measure your T-Slot dimensions as shown in diagram (A,B,C,D)
- Determine PSIG of plant air you can count on
- NOTE: System has minimum T-Slot restrictions and die requires smooth rolling surface to maximize efficiency

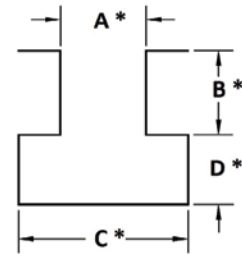

T-Slot Dimensions

**Measure dimension in 3 places: each end and middle of T-Slot*

Specialized Setups

Our Tee-Lift® System can be situated to meet the specific needs of die production lines with unique requirements:

- TL – Standard applications for 1" nominal T-Slot sizes
 - Capacity/per rail @ 85psi = 1,300 lbs/lineal ft approx.
- TLT – Standard applications for 3/4" nominal T-Slot sizes
 - Capacity/per rail @ 85psi = 900 lbs/lineal ft approx.
- HTTL – High-temperature applications (up to 350° F)
- DTL – Self-contained system for applications outside the bolster
- TLLR – Rollers fitted at 90° to the T-Slot direction for applications needing side-to-side movement
- DGL – Fitted with large-capacity lift rails for heavy-duty applications (up to 80 tons)

Additional Components

Customize your die production line with additional products from Wardcraft to streamline the handling of your dies on and off the presses:

- S-Rail™ – heavy-duty stationary roller system
- MS-Rail™ – medium-duty stationary roller system
- DI-CLAMP™ – patented half-turn mechanical die clamp
- DI-GLIDE® System – heavy-duty pneumatic die-lifting system (up to 80 tons)
- Bolster Extensions –available in both heavy- and medium-duty to aid in the die-removal process
- Die Tables
- Die Racks
- Die Carts

Tee Up Your Tee-Lift® System

Faster, more-efficient die handling is just a phone call or e-mail away. Wardcraft saves you time, money and hassles.